

Click here to email Sales@Eco-BuildingProducts.com
Click here to order online at Eco-BuildingProducts.com
Click here to call us at 231.399.0700

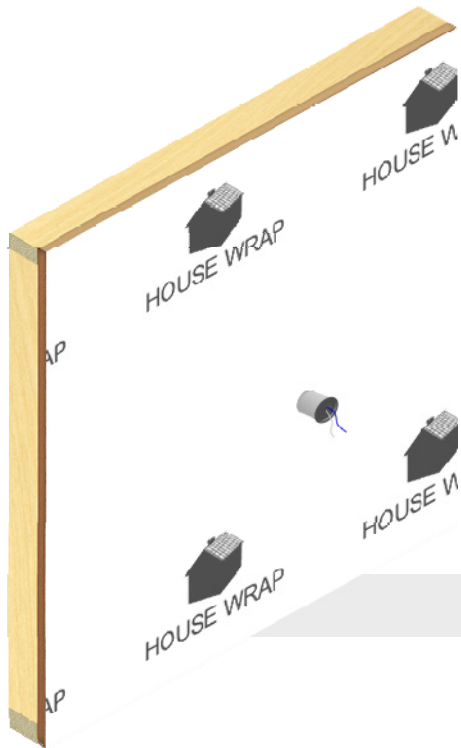

Installation Guide for Brick

IMPORTANT:
Always refer to house
wrap or building paper
manufacturers install
guidelines.

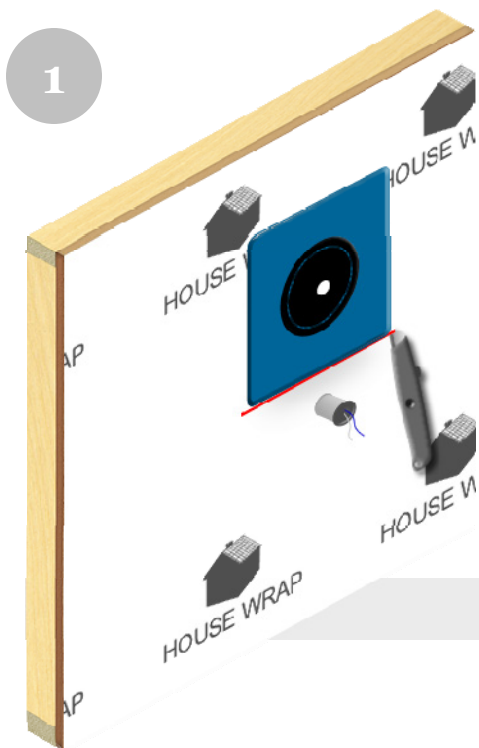

Using the Quickflash® panel as a guide, mark the length of the panel plus 1/4" on each side 2" above penetration onto the WRB and using a utility knife, cut a slit along the mark.

2

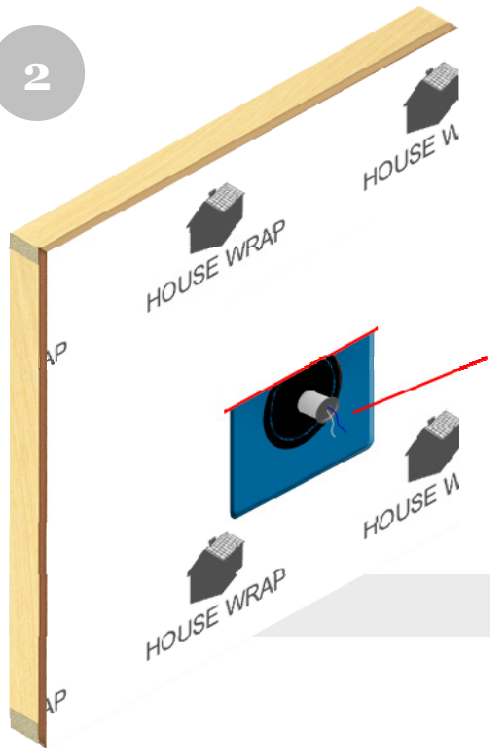

Slide the Quickflash® panel up underneath the WRB and over the penetration pressing down firmly to ensure a flush seal.

3

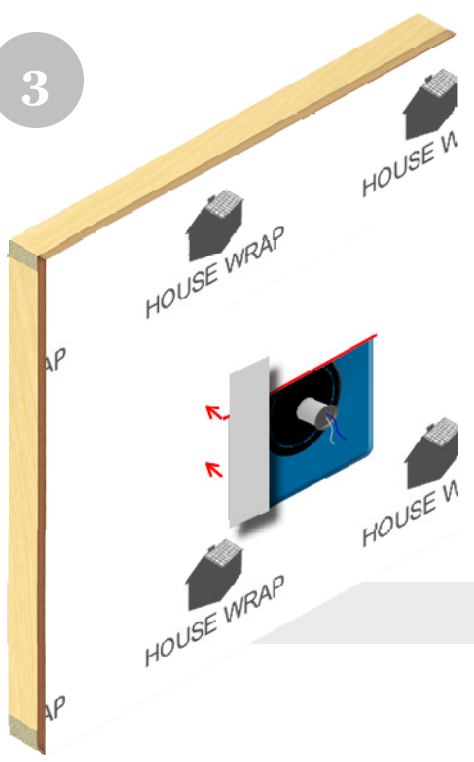

Tape on left side.

4

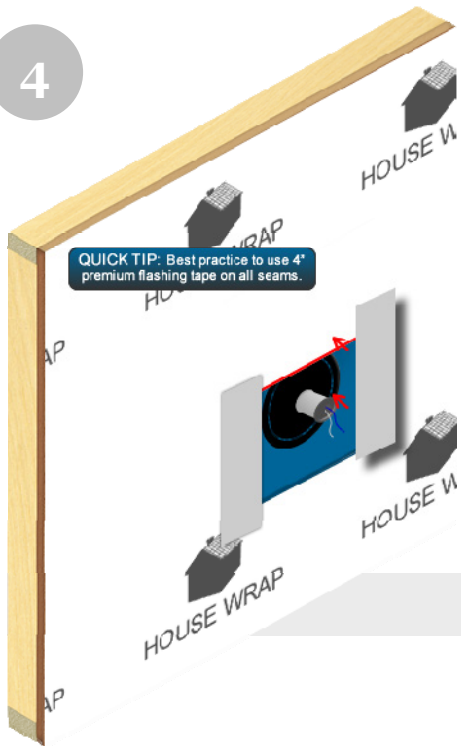

Tape on right side.

5

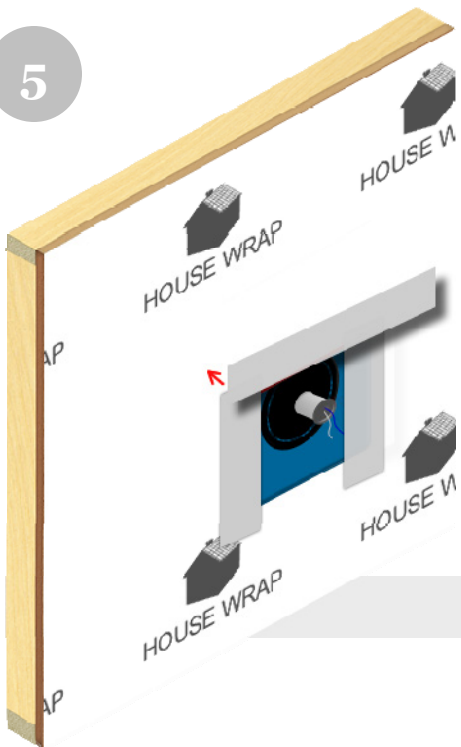

Tape across the top.

6

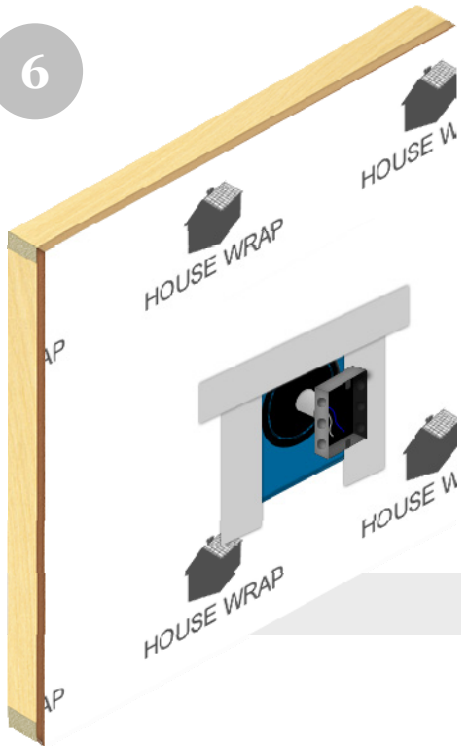

(If using for electrical)
Attach electrical box to
flexible conduit containing
wire.

7

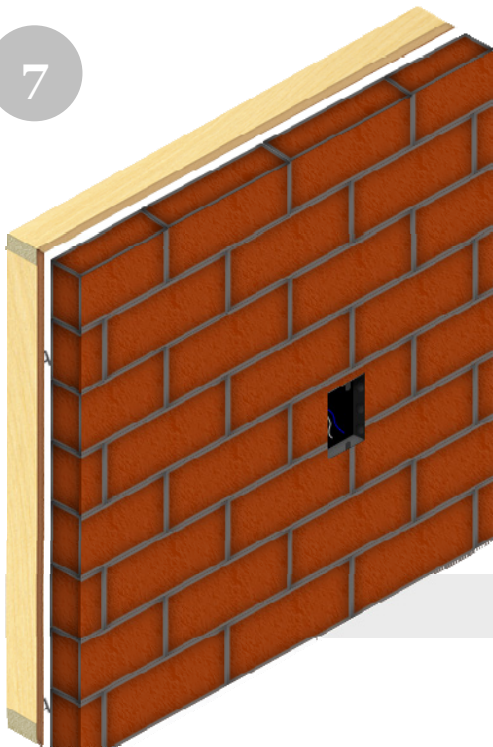

Install brick or cultured
stone.